



**AKRAPOVIC SLIP-ON STREET LEGAL EXHAUST SYSTEM  
for the  
YAMAHA MT01 (2004-2006) & MT01 (2007-)**

**Congratulations on purchasing an Akrapovic exhaust system. Please read these installation instructions carefully. If you have any trouble installing the system please contact your authorized dealer!**

**IMPORTANT INFORMATION**

**Exclusion of Certain Liability**

1. The manufacturer, importer or dealer shall not be liable for any incidental damage including personal injury or any other damages caused by improper installation or operation of the Akrapovic exhaust system. When installing the Akrapovic exhaust system be careful that the exhaust system does not touch other parts sensitive to high temperature.
2. Akrapovic makes no representation or warranties with regard to damage caused by the improper installation, use and maintenance of the Akrapovic exhaust system. The warranty is limited to defects recognized by our technical department and to normal use, and excludes items subject to normal wear (gaskets and damping wool). The guarantee is void in case of accident, modification, improper or competition use.
3. Do not attempt to install the Akrapovic exhaust system on a motorcycle for which it was not made or tested by Akrapovic.
4. When the exhaust system gets very hot during operation, be careful not to burn yourself on the exhaust system or parts which are in direct contact with it, even when the motor is not running. Also protect other people, especially children, from the injuries mentioned above.
5. In some cases Akrapovic exhaust system kits contain chemical products (ceramic anti-seizing grease; bolt sealant). Handle with care, do not inhale or swallow. Avoid excessive contact with skin, eyes or mucous membranes. Keep out of reach of children.
6. Technical specifications of Akrapovic exhaust systems and related products subject to change without notice.

**Trademarks**

The Akrapovic Exhaust System Technology logo is a registered trademark of Akrapovic d.d.

**Akrapovic website**

Information about Akrapovic exhaust systems and related products is available on the Akrapovic website at:  
**<http://www.akrapovic.com/>**

**Copyright**

No part of the Akrapovic exhaust system or its documentation may be reproduced or distributed in any form or by any means without the prior written authorization of the Akrapovic company.

© Akrapovic, d.d. All rights reserved.

**Symbols**

The following symbols are used throughout these installation instructions:



## INSTALLATION INSTRUCTIONS

 BEFORE INSTALLING CHECK SCHEMATIC OF THE EXHAUST SYSTEM!

 IF ANY ITEMS IN THE AKRAPOVIC EXHAUST SYSTEM PACKAGE ARE MISSING PLEASE CONTACT YOUR AUTHORIZED DEALER. KEEP THE SCHEMATIC FOR FUTURE REFERENCE.

 THESE INSTALLATION INSTRUCTIONS MUST BE READ CAREFULLY IN ORDER TO ENSURE PROPER INSTALLATION AND OPERATION OF THE AKRAPOVIC EXHAUST SYSTEM.

 THE EXHAUST SYSTEM CAN BE EXTREMELY HOT. ALLOW THE MOTORCYCLE TO COOL DOWN BEFORE BEGINNING INSTALLATION.

 WE ADVISE YOU TO LEAVE INSTALLATION TO A QUALIFIED SERVICEMAN. IMPROPER INSTALLATION MAY RESULT IN A SHORTER LIFETIME OF THE EXHAUST SYSTEM AND/OR DAMAGE TO THE MOTORCYCLE.

### REMOVAL OF STOCK EXHAUST SYSTEM

1. put the motorcycle on a side stand, we recommend a racing stand
2. unlock and remove the seat (**Figure 1, 2**)
3. unscrew the bolt and remove the trim ring from the outlet cap; repeat the process for the other muffler (**Figure 3, 4**)
4. unscrew the lower and side bolts from the muffler cowling; repeat the process for the other muffler (**Figure 5, 6**)
5. remove the inner flange from the outlet cap; repeat the process for the other muffler (**Figure 7**)
6. unscrew the upper bolt from the muffler cowling and remove the muffler cowling; repeat the process for the other muffler (**Figure 8, 9**)
7. unscrew the bolt from the metal clamp at the muffler – Y link pipe joint; repeat the process for the other muffler (**Figure 10**)
8. unscrew the bolt from the muffler chassis hanging bracket and remove the muffler; repeat the process for the other muffler (**Figure 11, 12**)
9. **for 2007 model only:** unscrew the bolt from the Y link pipe hanging bracket and the bolt from the metal clamp at the Y link pipe – collector joint (**Figure 13**)
10. **for 2007 model only:** remove the stock Y link pipe (**Figure 14**)

### INSTALLATION OF THE AKRAPOVIC SLIP-ON EXHAUST SYSTEM:

**Installing the Akrapovic Y link pipe with catalytic converter (for 2007- model only):**

1. install the Akrapovic metal clamp and press-on nut onto the Akrapovic Y link pipe (**Figure 15**)
2. attach the Y link pipe ; tighten the Y link pipe bracket and metal clamp (**Figure 16, 17**)

**installing the mufflers:**

1. fit the press-on nut onto the metal hanging bracket on the muffler; repeat the process for the other muffler (**Figure 18**)
2. slide the stock rubber distance washer onto the correct place on the Akrapovic muffler; repeat the process for the other muffler (**Figure 19**)
3. **for 2004-2006 models only:** insert the catalytic converters into mufflers' link pipes (**Figure 20**)
4. **for 2004-2006 models only (without Akrapovič Y link pipe):** insert **STOCK graphite sleeve gaskets** into the mufflers' link pipes (**Figure 21**)
5. **for 2007 model only (with Akrapovič Y link pipe):** insert **additional AKRAPOVIČ graphite sleeve gaskets** into the mufflers' link pipes (**Figure 21**)
6. position the muffler correctly and slide it onto the outlet side of the Y link pipe; repeat the process for the other muffler (**Figure 22**)
7. position the bolt for the muffler chassis hanging bracket; repeat the process for the other muffler (**Figure 23**)
8. attach the metal clamp at the Y link pipe – muffler joint; repeat the process for the other muffler (**Figure 24**)
9. make sure the mufflers are not touching other parts of the motorcycle
10. attach the carbon-fiber heat shields on both sides of the motorcycle (**Figure 25, 26**)

**final installation:**

1. reattach the seat (**Figure 27**)
2. position of the installed Akrapovic Slip-on Street Legal system (**Figure 28**)
3. clean grease spots:
  - a. muffler – titanium outer sleeve: use a soft cloth sprayed with a multi-purpose spray lubricant (WD-40 or equivalent)
  - b. titanium link pipes (welded on mufflers): use a soft cloth sprayed with a multi-purpose spray lubricant (WD-40 or equivalent)
  - c. stainless steel Y link pipe: use a soft cloth sprayed with a contact cleaner, then wipe with a soft dry cloth.
  - d. carbon-fiber outer sleeve heat shield: use a soft dry clothCleaning will prevent spots from burning onto the surface.

Check the operation of the brakes and suspension. Make sure all the bolts are sufficiently tightened. In case the exhaust system touches the cowling or other parts repeat the adjustment of the exhaust system or contact your authorized dealer.

 IT IS NORMAL IF WHITE SMOKE COMES OUT OF THE MUFFLER ON FIRST OPERATION.

 DO NOT STAND BEHIND THE MUFFLER ON FIRST OPERATION.

 DO NOT USE AUTOMOTIVE WHEEL CLEANERS OR ANY CLEANING PRODUCTS WHICH CONTAIN ACIDIC ADDITIVES TO CLEAN AKRAPOVIC EXHAUST SYSTEMS.

## MAINTENANCE OF THE AKRAPOVIC EXHAUST SYSTEM

1. Clean the titanium muffler outer sleeve with a multi-purpose spray lubricant (WD-40 or equivalent ) and carbon fiber components with a soft dry cloth. **Do not use aggressive chemical cleaners, because they can damage the aluminum parts of the exhaust system.** A change in the color of the exhaust system is normal due to the high temperatures.
2. The wearing out of the muffler silencing material depends on the type of the motor and riding style. Contact your dealer/serviceman if visible changes appear on muffler's outer sleeve or the noise level is increased.
3. Periodically ensure that all the bolts and springs are sufficiently tight.

### PHOTOS:



*Figure 1*



*Figure 2*



*Figure 3*



*Figure 4*



*Figure 5*



*Figure 6*



**Figure 7**



**Figure 8**



**Figure 9**



**Figure 10**



**Figure 11**



**Figure 12**



**Figure 13**



**Figure 14**



**Figure 15**



**Figure 16**



**Figure 17**



**Figure 18**



**Figure 19**



**Figure 20**



*Figure 21*



*Figure 22*



*Figure 23*



*Figure 24*



*Figure 25*



*Figure 26*



*Figure 27*



*Figure 28*

**YAMAHA MT-01 Homologated / Slip-on exhaust system, model year: 2004-2006**

**Product code: 103276 (S-YA16SO1-T)**

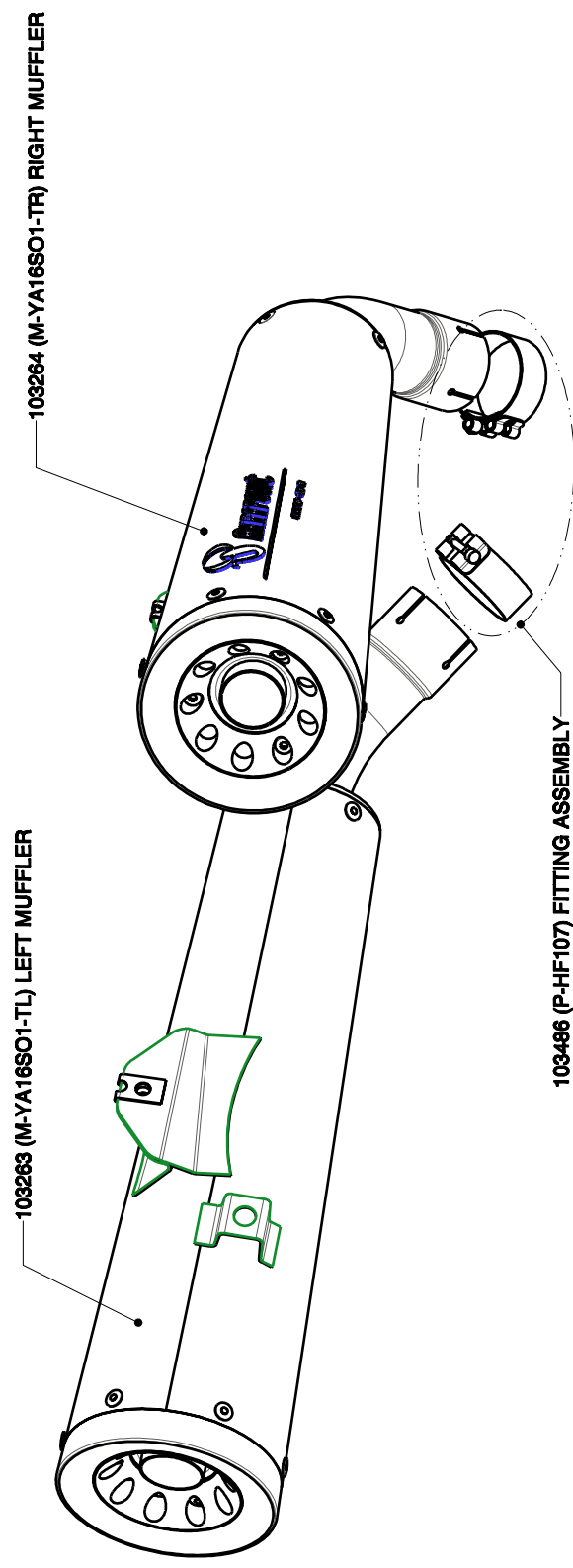



# Yamaha MT-01, Slip-on Exhaust System, Street legal, Model Year: 2007

## Product code: S-YA16SO2C-HT

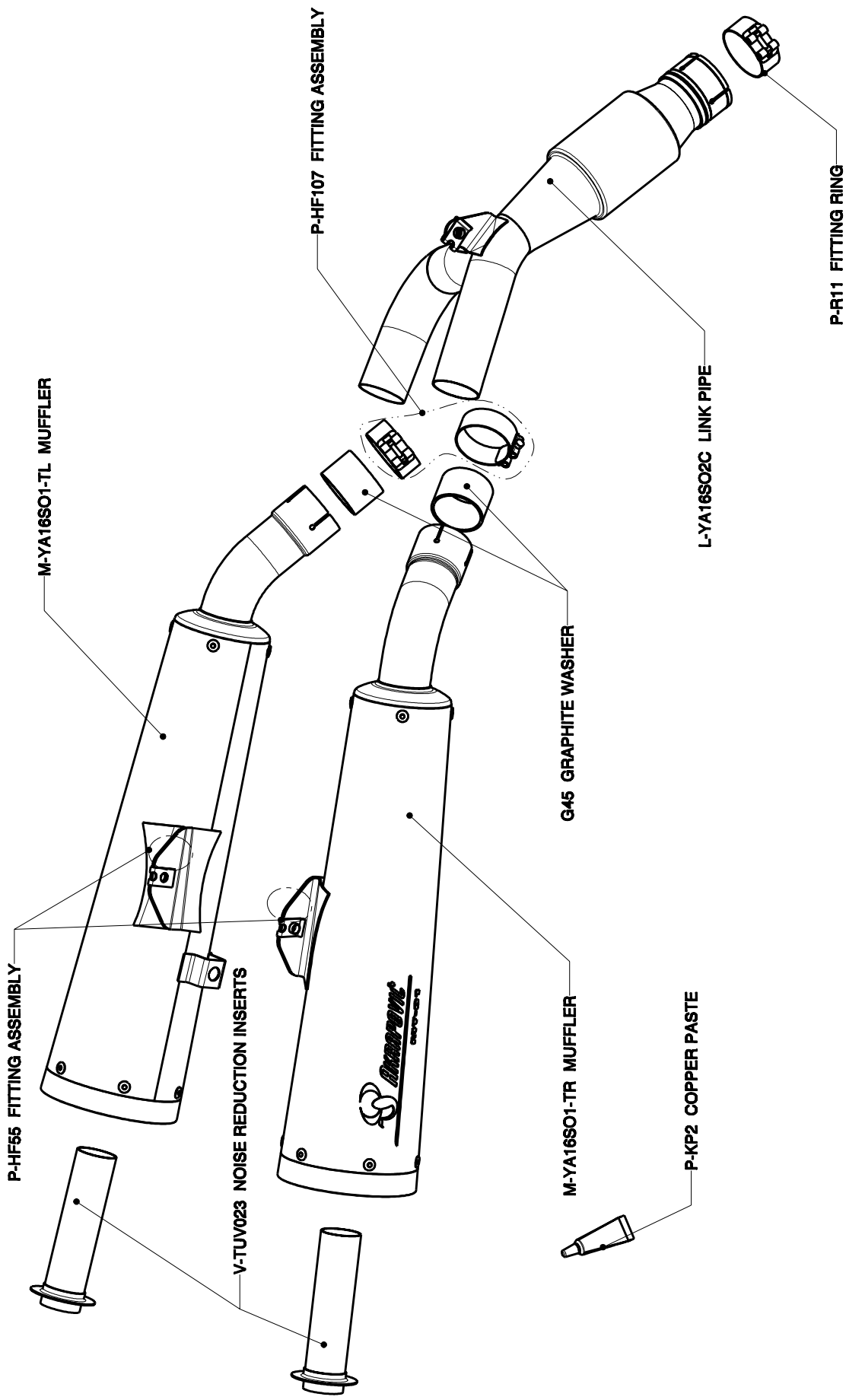

**WARNING:**

Please note that certain aftermarket exhaust systems may not comply with applicable California laws and regulations, and may therefore be prohibited for use on California highways or roads, or on roads or vehicles otherwise subject to emissions control requirements.

Akrapovič exhaust systems for automobiles and motorcycles mounted downstream of the catalytic converter (also known as “cat-back systems”) are considered “replacement parts” in California by the California Air Resources Board (CARB), and do not require an exemption or executive order from CARB to be sold in California. However, California prohibits the use of any aftermarket exhaust system that modifies, removes or replaces original equipment catalysts, unless CARB has issued an Executive Order as to such part or system.

Further, Akrapovič parts or exhaust systems used or intended for use on “racing vehicles” (i.e. a competition vehicle used exclusively for competition on closed-course circuits) do not require an exemption or Executive Order from CARB to be sold in California. However, such parts are prohibited from use on California public highways or roads, even if occasionally used “off-road.”